 Assembly and disassembly instructions
with special cleaning instructions

ADDplus™

anterior distraction device plus



Notes on assembly and disassembly instructions

This document lists all of the assembly and disassembly instructions available for the *ADDplus* system. The instruments must be disassembled according to the manufacturer's instructions in order to guarantee the processing and storage.

The product descriptions in the component overview are listed in English according to the labeling on the instruments.

 The user must ensure that the current versions of the system-related surgical technique and the "Processing manual implants and instruments" UH 1100 are on hand and are followed. These are also available at: **www.ifu.ulrichmedical.com**.

Contents

ADDplus™ Assembly and disassembly instructions for CS 1324	4	1
ADDplus™ Assembly and disassembly instructions for CS 2256-XX	6	2
ADDplus™ Assembly and disassembly instructions for CS 2261	10	3
ADDplus™ Assembly and disassembly instructions for CS 5789	11	4

ADDplus™

Assembly and disassembly instructions for CS 1324

1

Components involved:

No.	Product no.	Product description
1	CS 1324-1	Depth stop
2	CS 1324-2	Depth adjustor for CS 1324-1
3	CS 1324-3	Locking nut for CS 1324-1

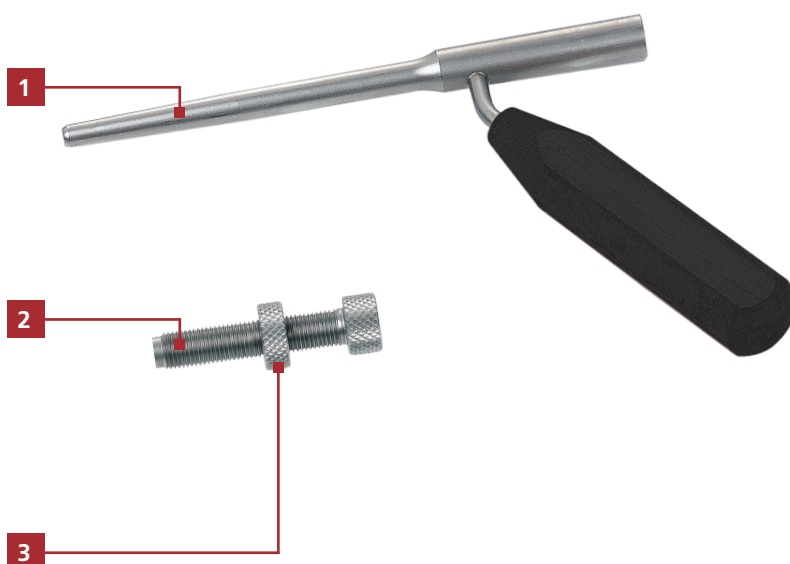

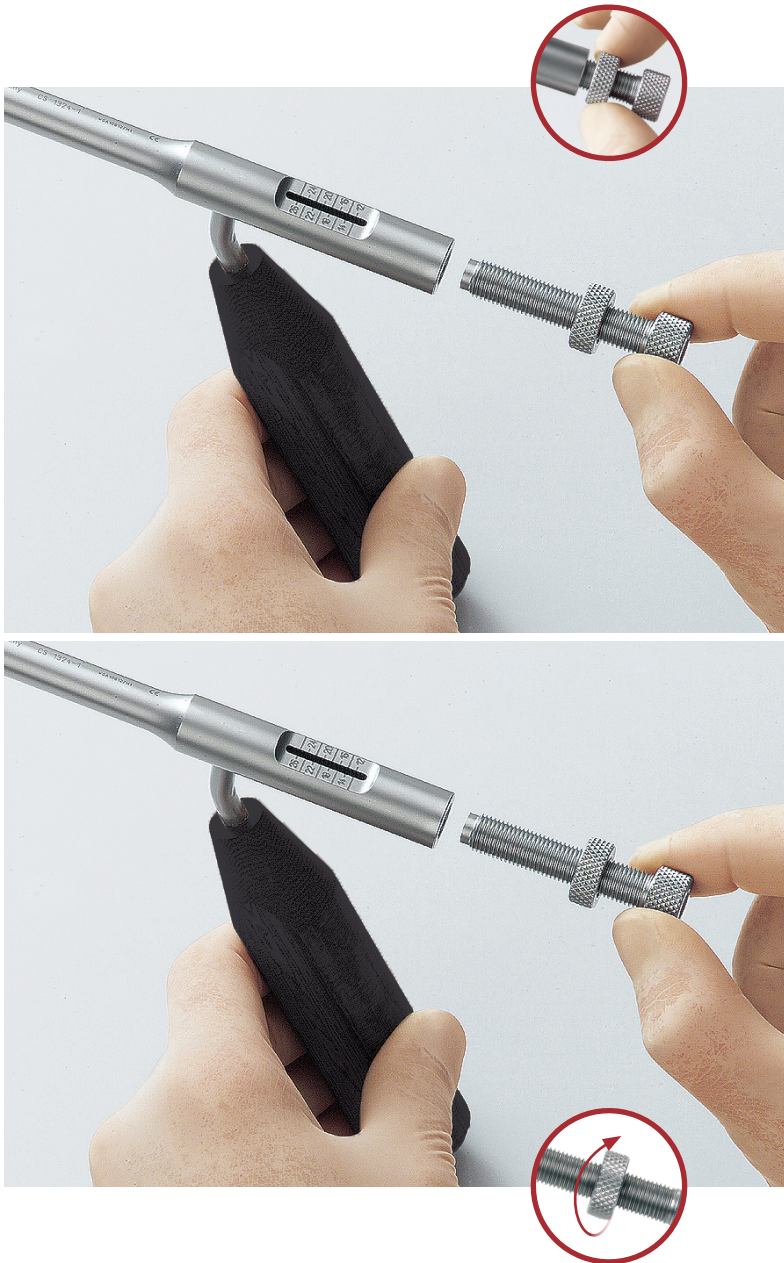

Assembly instructions

Assembly of the depth stop

CS 1324-3 is screwed onto CS 1324-2. CS 1324-2 is screwed into CS 1324-1 with CS 1324-3. The respective depth can be set on CS 1324-1 with CS 1324-3.

Disassembly instructions

CS 1324 must be disassembled for cleaning.

Disassembling the depth stop

CS 1324-3 is loosened and CS 1324-2 is unscrewed from CS 1324-1.

Then CS 1324-3 is completely turned down from CS 1324-2 for cleaning. CS 1324-3 is screwed onto CS 1324-2 again for subsequent storage in the tray.

Special cleaning instructions

No special cleaning instructions.

In addition, the general cleaning instructions of the Processing manual implants and instruments UH 1100 also apply.

ADDplus™

Assembly and disassembly instructions for CS 2256-XX

Components involved:

No.	Product no.	Product description
1	CS 2256-22	Locking rod, short, 276 mm
2	CS 2256-21	Inner shaft, short, 214 mm
3	CS 2256-20	Outer shaft, short, 128 mm
4	CS 2256-01	Handle
5	CS 2269-12	Head re-usable Ø 12 mm





Assembly instructions

Assembly of the distraction instrument

Insert CS 2256-21 into CS 2256-20.



Firmly attach CS 2256-01 to CS 2256-21.



Insert CS 2256-22 into the instrument through CS 2256-01. Ensure that CS 2256-22 remains freely movable.



Illustration with implant

Take CS 2269-12 and insert the rear end of CS 2269-12 completely into CS 2256-20 from the front.

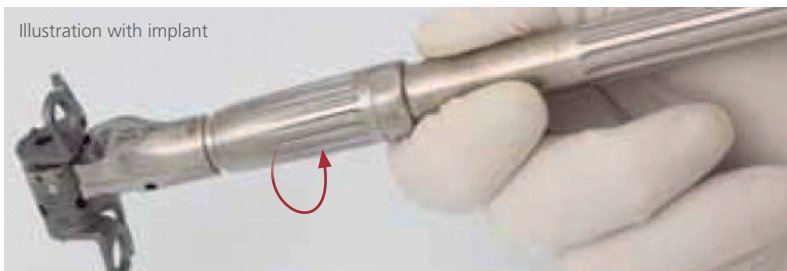

Illustration with implant

Secure CS 2269-12 to the instrument by turning the grooved part of CS 2256-20 clockwise until it sits firmly above CS 2269-12.

ADDplus™

Assembly and disassembly instructions for CS 2256-XX

2

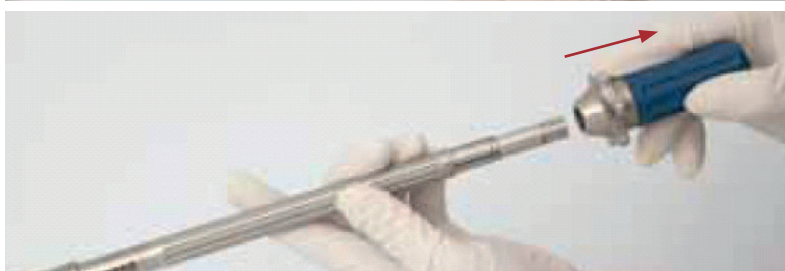

Disassembly instructions

CS 2256-XX must be disassembled for cleaning and also for storage on the tray.

Release CS 2269-12 from the instrument by turning the grooved part of CS 2256-20 counter-clockwise.

Pull CS 2269-12 completely out of CS 2256-20.

Pull CS 2256-22 completely out of the instrument.

Pull on CS 2256-01 until it completely detaches from CS 2256-21.

Pull CS 2256-21 out of CS 2256-20.

Special cleaning instructions

No special cleaning instructions.

In addition, the general cleaning instructions of the Processing manual implants and instruments UH 1100 also apply.

ADDplus™

Assembly and disassembly instructions for CS 2261

Components involved:

No.	Product no.	Product description
1	CS 2261	Screwdriver with holder, hex 2.5 mm

3



Disassembly instructions

CS 2261 must be disassembled for cleaning and also for storage on the tray.

Disassembling the screwdriver

The holder is retained on the screwdriver by means of a bayonet lock. In order to release the holder, the screwdriver and the holder must be separated from each other by turning in opposite directions. Then the holder can be pushed off of the screwdriver.

Special cleaning instructions

No special cleaning instructions.

In addition, the general cleaning instructions of the Processing manual implants and instruments UH 1100 also apply.

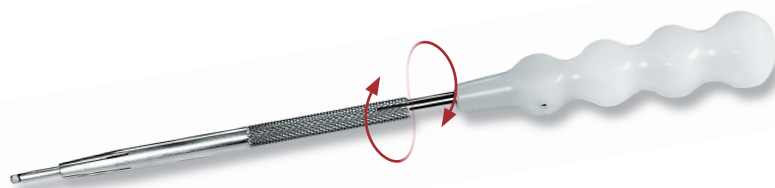

ADDplus™

Assembly and disassembly instructions for CS 5789

Components involved:

No.	Product no.	Product description
1	CS 5789	Depth gauge, length 225 mm



Special cleaning instructions

No special cleaning instructions.

In addition, the general cleaning instructions of the Processing manual implants and instruments UH 1100 also apply.



Over a Century
of Innovation



Ulrich GmbH & Co. KG | Buchbrunnenweg 12 | 89081 Ulm | Germany
Phone: +49 (0)731 9654-0 | Fax: +49 (0)731 9654-2705
spine@ulrichmedical.com | www.ulrichmedical.com